

# Installation Manual

PEUGEOT 308 ESTATE  
PEU-308-E-B



## COMPONENTS INCLUDED

## SHADES

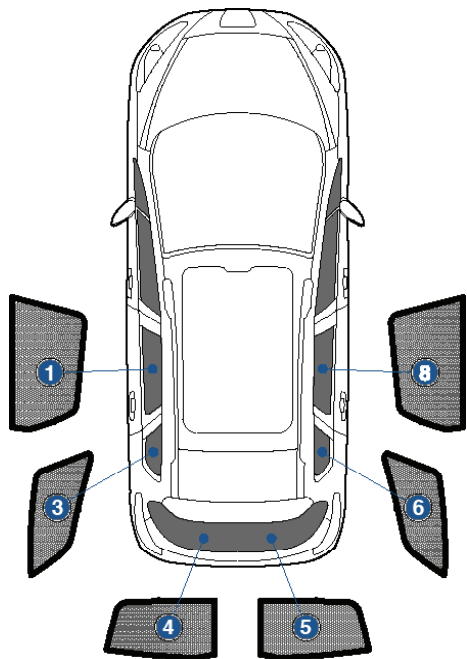

## FIXING CLIPS



CL-M02 x 2



CL-M12 x 4



CL-M05 x 2



CL-M14 x 1



CL-T01 x 1

# Side Shade Installation

PEUGEOT 308 ESTATE  
PEU-308-E-B

COMPONENTS NEEDED:



## STEP #1

INSERT CLIPS INSIDE WEATHERSTRIP



## STEP #2

POSITION THE SIDE SHADE

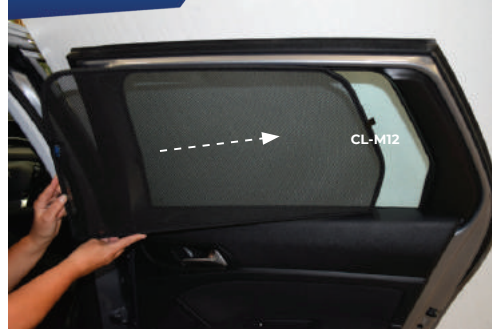

## STEP #3

ATTACH SIDE SHADE BEHIND CLIPS



## STEP #4

ENSURE SECURELY FITTED IN PLACE

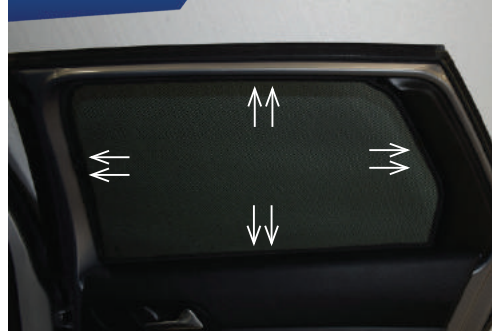

**CAR**  
SHADES

# Quarter Light Shade Installation

PEUGEOT 308 ESTATE  
PEU-308-E-B

COMPONENTS NEEDED:

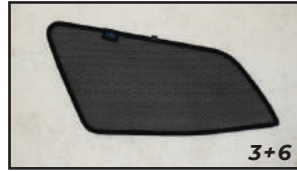

## STEP #1

ATTACH CLIPS ON SHADE EDGES



## STEP #2

INSERT CLIPS BEHIND INTERIOR TRIM



## STEP #3

ENSURE SECURELY FITTED IN PLACE

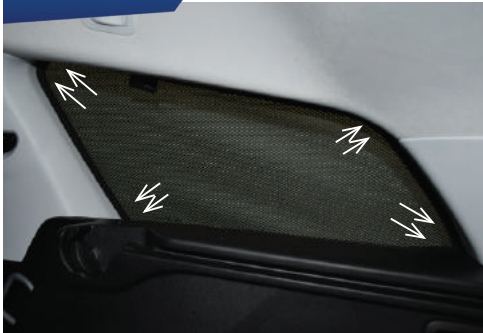

**CAR**  
SHADES

# Rear Shade Installation

PEUGEOT 308 ESTATE  
PEU-308-E-B

## COMPONENTS NEEDED:

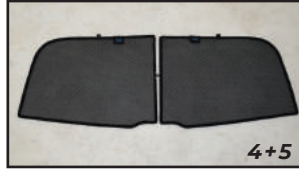

CL-M12 x 2



CL-M14 x 1

### STEP #1

ATTACH CLIPS ON SHADE EDGES



### STEP #2

POSITION THE REAR SHADE

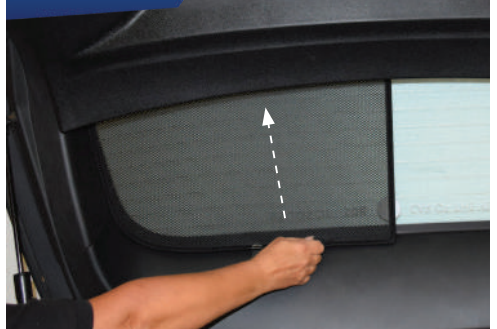

### STEP #3

INSERT CLIPS BEHIND INTERIOR TRIM



### STEP #4

REPEAT THE PROCESS ON OTHER SHADE



### STEP #5

ENSURE SECURELY FITTED IN PLACE

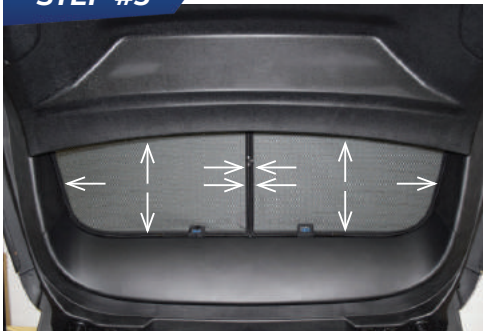

**CAR**  
SHADES