

Installation Manual

FORD BMAX
FOR-BMAX-5-A



COMPONENTS INCLUDED

SHADES

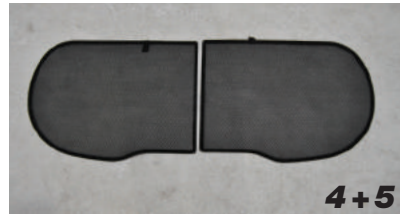
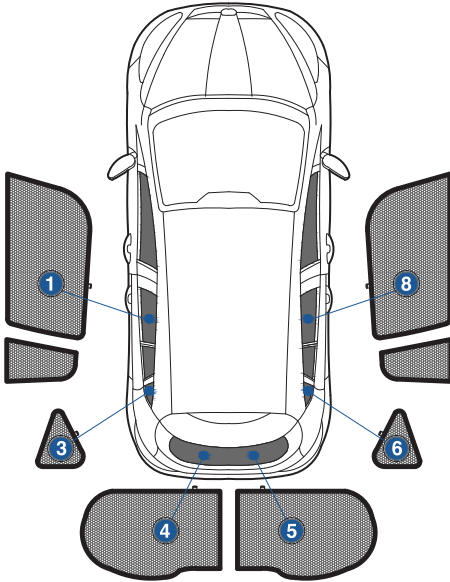

FIXING CLIPS



CL-M04 x 4



CL-M12 x 2



CL-M05 x 2



CL-M13 x 2



CL-M14 x 1



CL-T01 x 1

Side Shade (A) Installation

FORD BMAX
FOR-BMAX-5-A

COMPONENTS NEEDED:

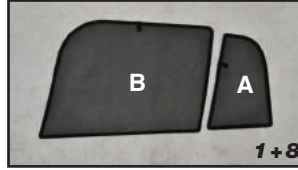

CL-M05 x 1



CL-M04 x 1

STEP #1

ATTACH CLIPS ON SHADE EDGES



STEP #2

POSITION THE SIDE SHADE



STEP #3

INSERT CLIPS BEHIND INTERIOR TRIM



STEP #4

ENSURE SECURELY FITTED IN PLACE

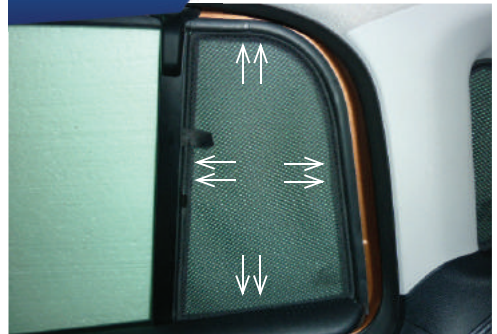

CAR
SHADES

Side Shade (B) Installation

FORD BMAX
FOR-BMAX-5-A

COMPONENTS NEEDED:

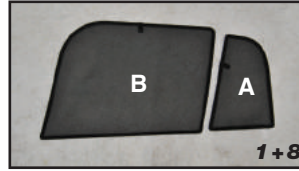

STEP #1

INSERT CLIPS INSIDE WEATHER-



STEP #2

POSITION THE SIDE SHADE

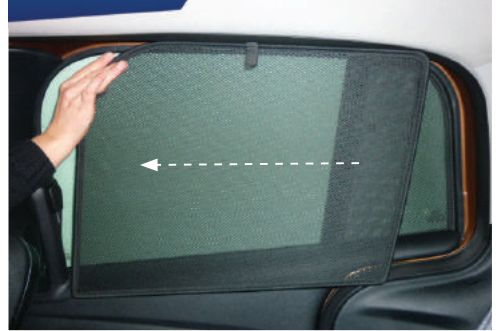

STEP #3

ATTACH SIDE SHADE BEHIND CLIPS



STEP #4

ENSURE SECURELY FITTED IN PLACE



Quarter Light Shade Installation

FORD BMAX

FOR-BMAX-5-A

COMPONENTS NEEDED:



STEP #1

ATTACH CLIPS ON SHADE EDGES



STEP #2

INSERT CLIPS BEHIND INTERIOR TRIM



STEP #3

ENSURE SECURELY FITTED IN PLACE



Rear Shade Installation

FORD BMAX
FOR-BMAX-5-A

COMPONENTS NEEDED:



STEP #1 ATTACH CLIPS ON SHADE EDGES



STEP #2 POSITION THE REAR SHADE

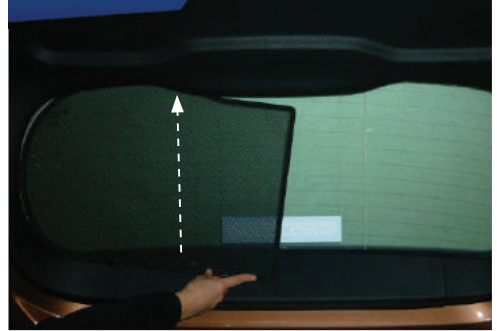

STEP #3 INSERT CLIPS BEHIND INTERIOR TRIM

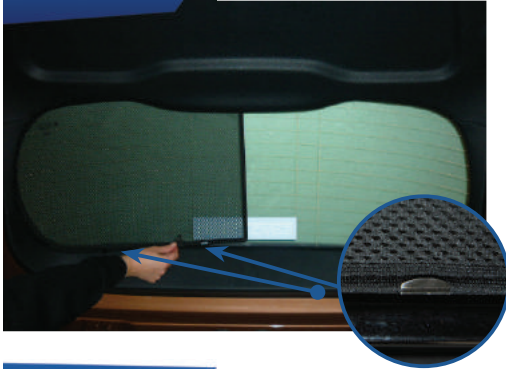

STEP #4 REPEAT THE PROCESS ON OTHER SHADE

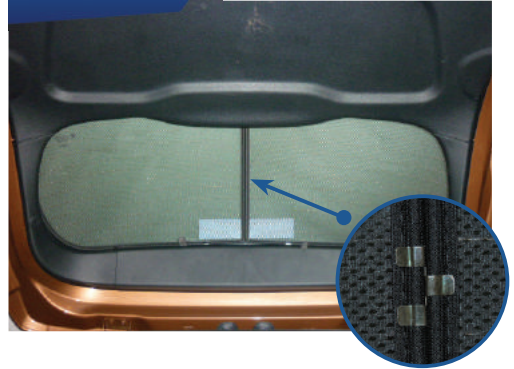

STEP #5 ENSURE SECURELY FITTED IN PLACE

