

Installation Manual

BMW X1 5DR
BMW-X1-5-A



COMPONENTS INCLUDED

SHADES

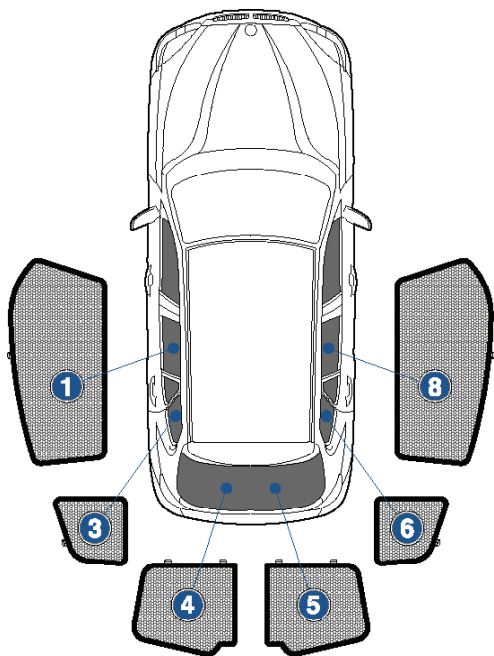

FIXING CLIPS



CL-M02 x 6



CL-M03 x 4



CL-M14 x 1



Side Shade Installation

BMW X1 5DR
BMW-X1-5-A

COMPONENTS NEEDED:



STEP #1

ATTACH CLIPS ON SHADE EDGES



STEP #2

POSITION THE SIDE SHADE



STEP #3

INSERT CLIPS INSIDE WEATHERSTRIP

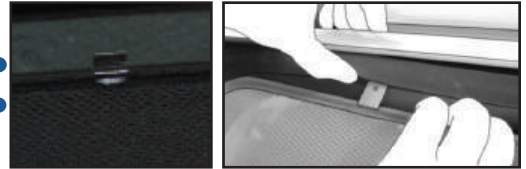

STEP #4

ENSURE SECURELY FITTED IN PLACE

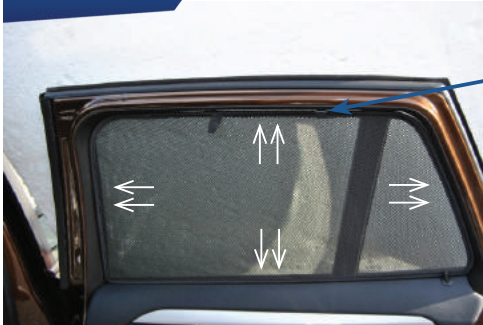

CAR
SHADES

Quarter Light Shade Installation

BMW X1 5DR
BMW-X1-5-A

COMPONENTS NEEDED:

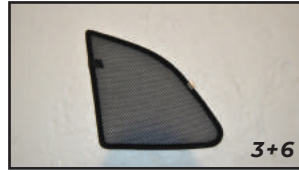

STEP #1

ATTACH CLIPS ON SHADE EDGES

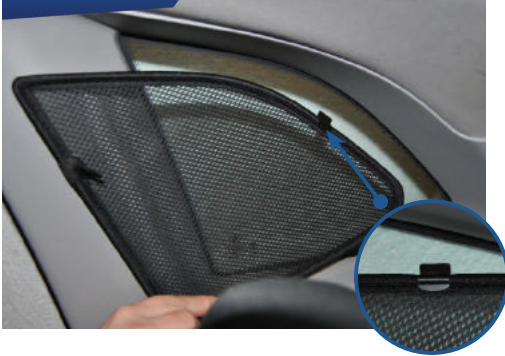

STEP #2

INSERT CLIPS BEHIND INTERIOR TRIM



STEP #3

ENSURE SECURELY FITTED IN PLACE



CAR
SHADES

Rear Shade Installation

BMW X1 5DR
BMW-X1-5-A

COMPONENTS NEEDED:

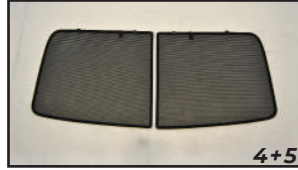

STEP #1

ATTACH CLIPS ON SHADE EDGES

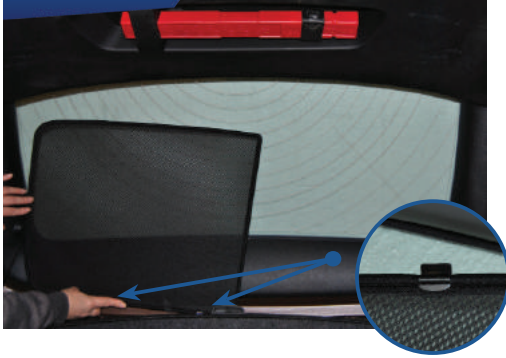

STEP #2

POSITION THE REAR SHADE

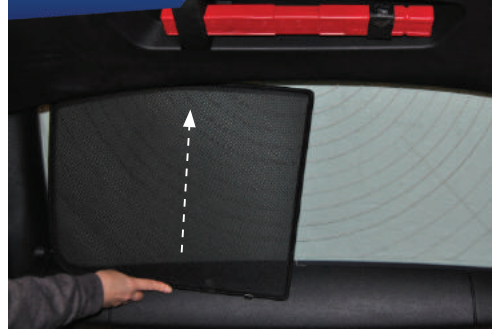

STEP #3

INSERT CLIPS BEHIND INTERIOR TRIM



STEP #4

REPEAT THE PROCESS ON OTHER SHADE



STEP #5

ENSURE SECURELY FITTED IN PLACE



CAR
SHADES