

# Installation Manual

BMW X4 5DR  
BMW-X4-5-A



COMPONENTS INCLUDED

SHADES

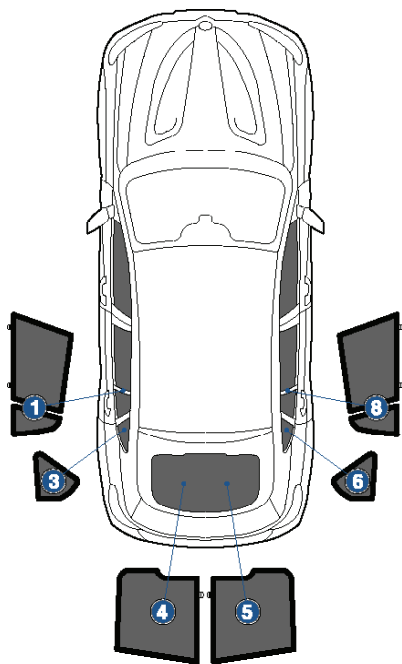

FIXING CLIPS



CL-M12 x 2



CL-M04 x 6



CL-M13 x 4



CL-M14 x 1

# Side Shade (A) Installation

BMW X4 5DR  
BMW-X4-5-A

COMPONENTS NEEDED:

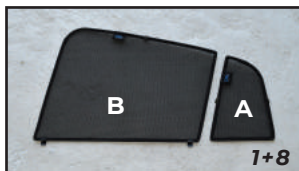

## STEP #1

ATTACH CLIPS ON SHADE EDGES



## STEP #2

POSITION THE SIDE SHADE



## STEP #3

INSERT CLIPS BEHIND INTERIOR TRIM



## STEP #4

ENSURE SECURELY FITTED IN PLACE



**CAR**  
SHADES

# Side Shade (B) Installation

BMW X4 5DR  
BMW-X4-5-A

COMPONENTS NEEDED:

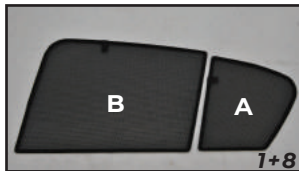

## STEP #1

ATTACH CLIPS ON SHADE EDGES



## STEP #2

POSITION THE SIDE SHADE

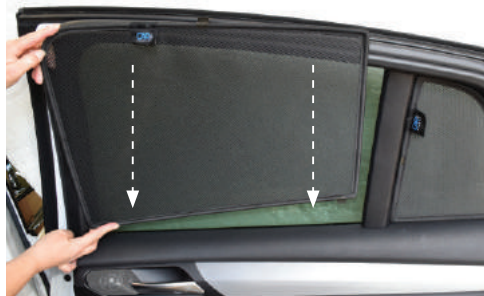

## STEP #3

INSERT CLIPS BEHIND INTERIOR TRIM



## STEP #4

ENSURE SECURELY FITTED IN PLACE

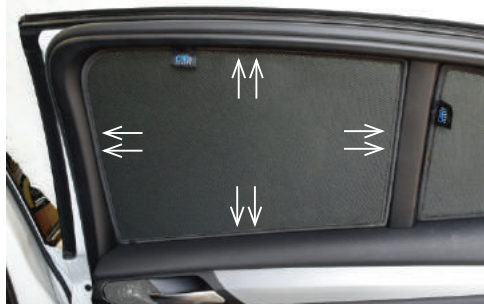

**CAR**  
SHADES

# Quarter Light Shade Installation

BMW X4 5DR  
BMW-X4-5-A

COMPONENTS NEEDED:



## STEP #1

ENSURE SECURELY FITTED IN PLACE

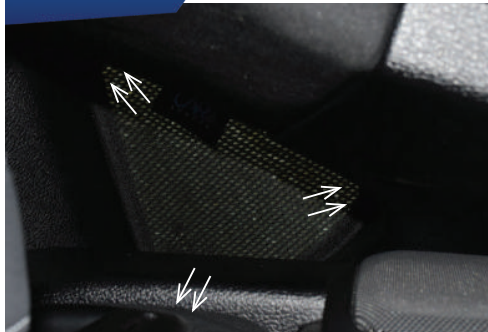

# Rear Shade Installation

BMW X4 5DR  
BMW-X4-5-A

COMPONENTS NEEDED:



## STEP #1

ATTACH CLIPS ON SHADE EDGES



## STEP #2

POSITION THE REAR SHADE

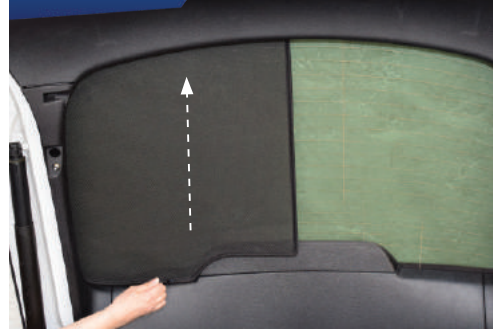

## STEP #3

INSERT CLIPS BEHIND INTERIOR TRIM



## STEP #4

REPEAT THE PROCESS ON OTHER SHADE



## STEP #5

ENSURE SECURELY FITTED IN PLACE



**CAR**  
SHADES