

# Installation Manual

AUDI A6 EST  
AU-A6-E-C



## COMPONENTS INCLUDED

## SHADES

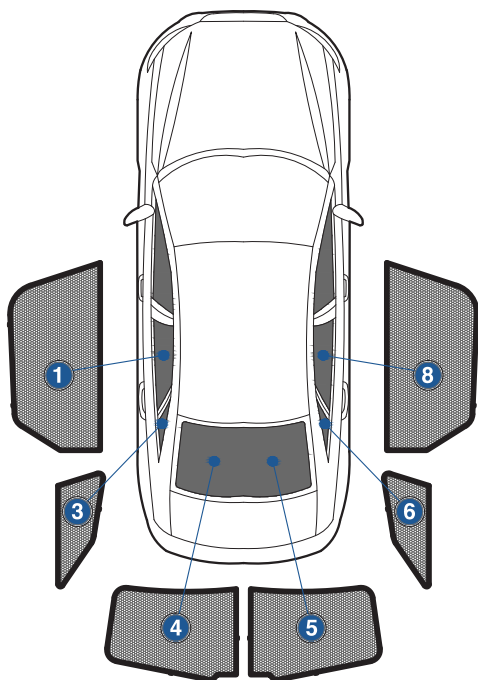

## FIXING CLIPS



CL-M02 x 2



CL-M14 x 1



CL-M12 x 8



# Side Shade Installation

AUDI A6 EST  
AU-A6-E-C

## COMPONENTS NEEDED:



### STEP #1

ATTACH CLIPS ON SHADE EDGES

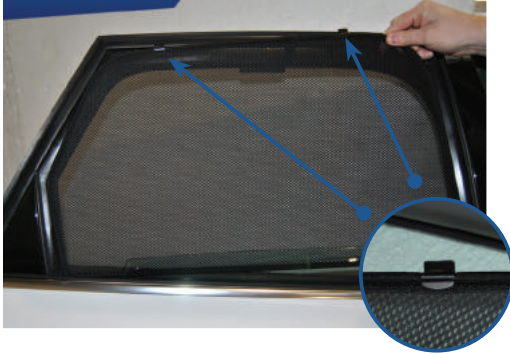

### STEP #2

POSITION THE SIDE SHADE



### STEP #3

INSERT CLIPS INSIDE WEATHERSTRIP

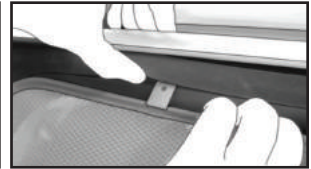
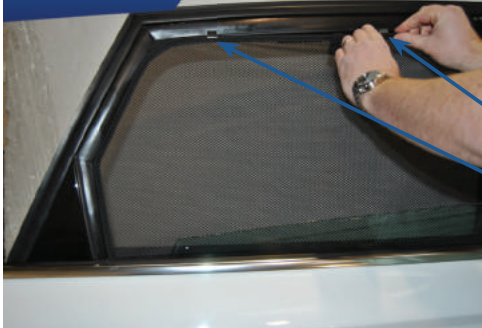

### STEP #4

ENSURE SECURELY FITTED IN PLACE

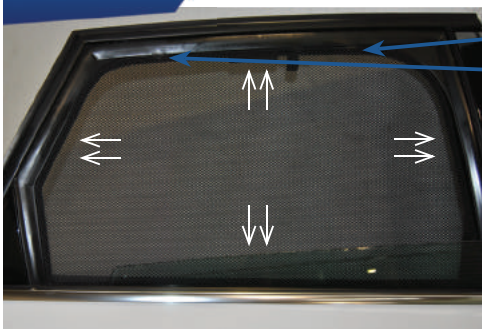

**CAR**  
SHADES

# Quarter Light Shade Installation

AUDI A6 EST  
AU-A6-E-C

## COMPONENTS NEEDED:

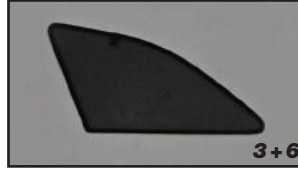

### STEP #1

ATTACH CLIPS ON SHADE EDGES



### STEP #2

INSERT CLIPS BEHIND INTERIOR TRIM



### STEP #3

ENSURE SECURELY FITTED IN PLACE



# Rear Shade Installation

AUDI A6 EST  
AU-A6-E-C

## COMPONENTS NEEDED:



### STEP #1

ATTACH CLIPS ON SHADE EDGES



### STEP #2

POSITION THE REAR SHADE

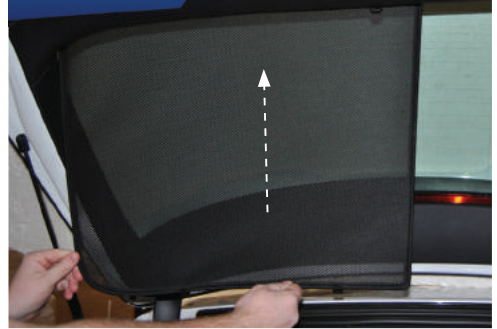

### STEP #3

INSERT CLIPS BEHIND INTERIOR TRIM



### STEP #4

REPEAT THE PROCESS ON OTHER SHADE



### STEP #5

ENSURE SECURELY FITTED IN PLACE

